

# Storage & Handling

## DDL Stop/Start Guide

Questions about your Digital Data Logger (DDL)? Contact our Storage and Handling team at [TempCheck@phila.gov](mailto:TempCheck@phila.gov) or 215-685-6777

# Stopping the DDL

## Step One: Stop your DDL

- Press and hold the *Start/Clear/Stop button* until the word **STOPPED** appears on the screen (fig. 1).
- When **REC•** disappears, release the *button* immediately.
- Your DDL is now in **stopped mode** (fig.2).

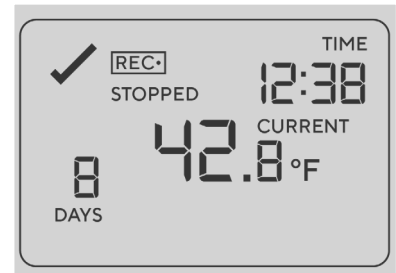

fig. 1

## Step Two: Disconnect the Probe

- Unplug your DDL from its probe (fig.3).



fig. 2

## Step Three: Download Data

- Take your DDL to your computer, open the software and insert the logger in the docking station to download the data.

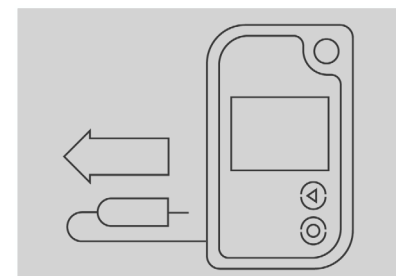

fig. 3

# Storage & Handling

## DDL Stop/Start Guide

Questions about your Digital Data Logger (DDL)? Contact our Storage and Handling team at [TempCheck@phila.gov](mailto:TempCheck@phila.gov) or 215-685-6777

# Starting the DDL

## Step One: Connect Your DDL to the Probe

- Reconnect the probe to your DDL (fig. 4)

## Step Two: Start Your DDL

Your DDL must be in **ready mode** to start as shown in fig. 5. If your DDL is not in ready mode, please contact [TempCheck@phila.gov](mailto:TempCheck@phila.gov) for troubleshooting.

- Press and hold the *Start/Clear/Stop button*. **STARTING** will appear (fig. 6).
- When **READY** disappears, **release the button immediately**.
- **STARTING** will be replaced with **REC•** and the current temperature reading will appear (fig. 7). **Your DDL is now recording temperature!**

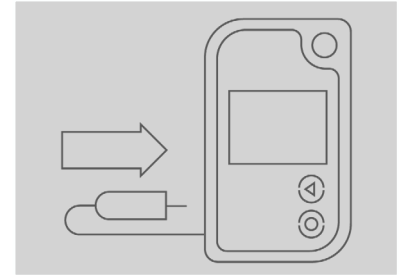

fig. 4



fig. 5



fig. 6

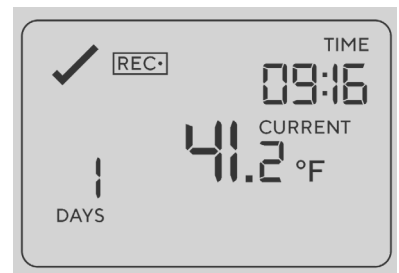

fig. 7

# Storage & Handling

## DDL Stop/Start Guide

Questions about your Digital Data Logger (DDL)? Contact our Storage and Handling team at [TempCheck@phila.gov](mailto:TempCheck@phila.gov) or 215-685-6777

### Stopping the DDL

#### Step One: Stop your DDL

- Press and hold the *Start/Clear/Stop button* until the word **STOPPED** appears on the screen (fig. 1).
- When **REC•** disappears, release the *button* immediately.
- Your DDL is now in **stopped mode** (fig.2).



fig. 1



fig. 2

#### Step Two: Disconnect the Probe

- Unplug your DDL from its probe (fig.3).

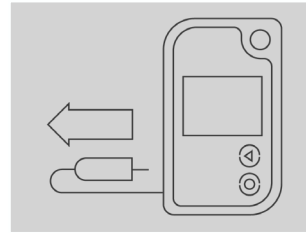

fig. 3

#### Step Three: Download Data

- Take your DDL to your computer, open the software and insert the logger in the docking station to download the data.

Philadelphia Department of Public Health - Division of Disease Control - Immunization Program -Storage & Handling  
1101 Market St. Floor 12, Philadelphia, PA, 19107 | [vax.phila.gov](http://vax.phila.gov) | [TempCheck@phila.gov](mailto:TempCheck@phila.gov) | June 2022



# Storage & Handling

## DDL Stop/Start Guide

Questions about your Digital Data Logger (DDL)? Contact our Storage and Handling team at [TempCheck@phila.gov](mailto:TempCheck@phila.gov) or 215-685-6777

### Starting the DDL

#### Step One: Connect Your DDL to the Probe

- Reconnect the probe to your DDL (fig. 4)

#### Step Two: Start Your DDL

Your DDL must be in **ready mode** to start as shown in fig. 5. If your DDL is not in ready mode, please contact [TempCheck@phila.gov](mailto:TempCheck@phila.gov) for troubleshooting.

- Press and hold the *Start/Clear/Stop button*. **STARTING** will appear (fig. 6).
- When **READY** disappears, **release the button immediately**.
- **STARTING** will be replaced with **REC•** and the current temperature reading will appear (fig. 7). **Your DDL is now recording temperature!**

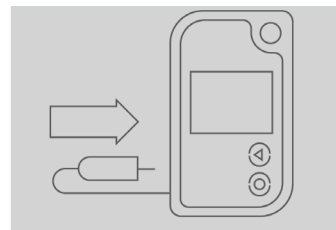

fig. 4



fig. 5



fig. 6

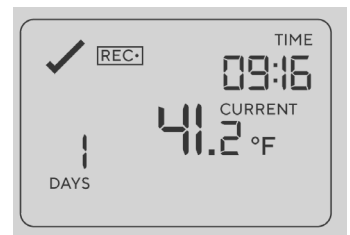

fig. 7

Philadelphia Department of Public Health - Division of Disease Control - Immunization Program -Storage & Handling  
1101 Market St. Floor 12, Philadelphia, PA, 19107 | [vax.phila.gov](http://vax.phila.gov) | [TempCheck@phila.gov](mailto:TempCheck@phila.gov) | June 2022

